

- 3/4" Plywood (min.)
- Water and Air Resistive Barrier
- Omawall Panel
- High Impact Plastic Shim (as required)
- Membrane Strip
- #10 x 1" Wafer Head Screw
- Angle Trim
- J Channel
- Backer Rod and Sealant

Note1

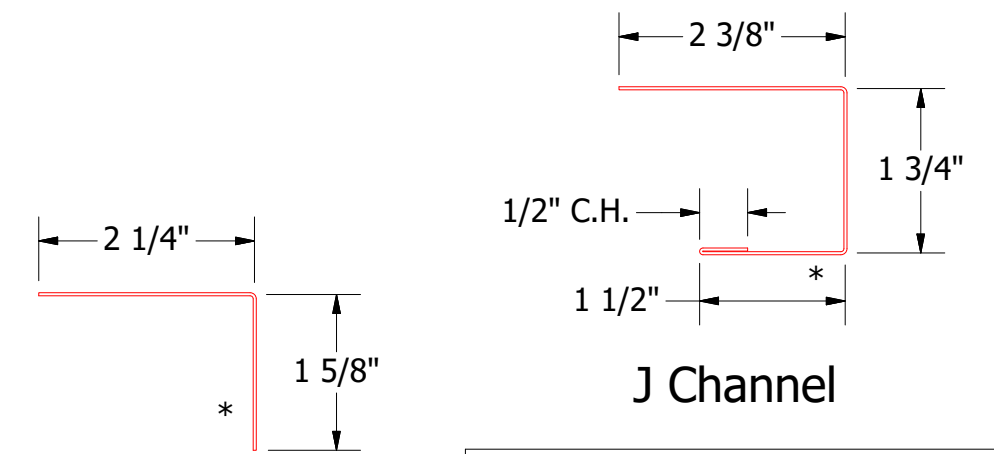
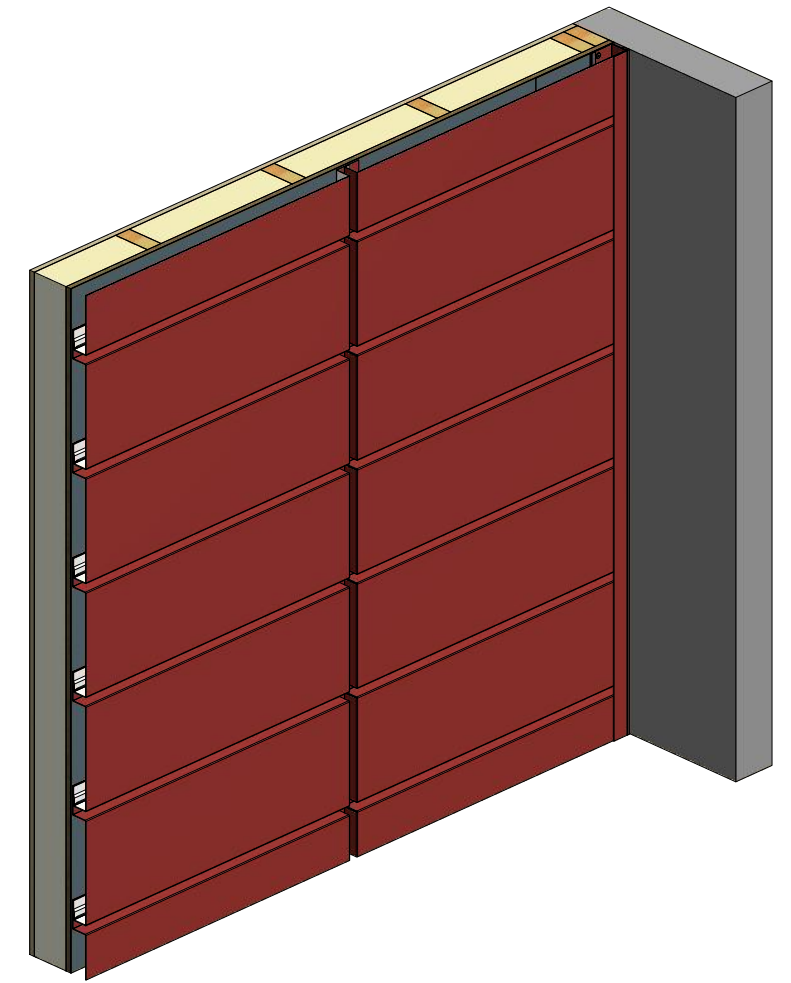

Angle Trim

J Channel

Note: * denotes color side.
 Note1: Cut Back Panel Edge.

REV. NO.				DATE				DESCRIPTION OF REVISION				BY		APP	
TITLE				Omawall Endwall Detail				DWG. NO.		DR		DATE		1/26/2021	
MATERIAL				SH. SIZE				APP		KRK		DATE		SCALE	
				B								X:X			

ATAS INTERNATIONAL, INC
 Allentown PA
 610-395-8445
 Mesa AZ
 480-558-7210